

i-on

Next Generation

Quick User Guide

Hold prox tag near face of keypad.

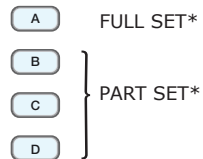
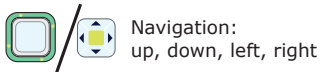
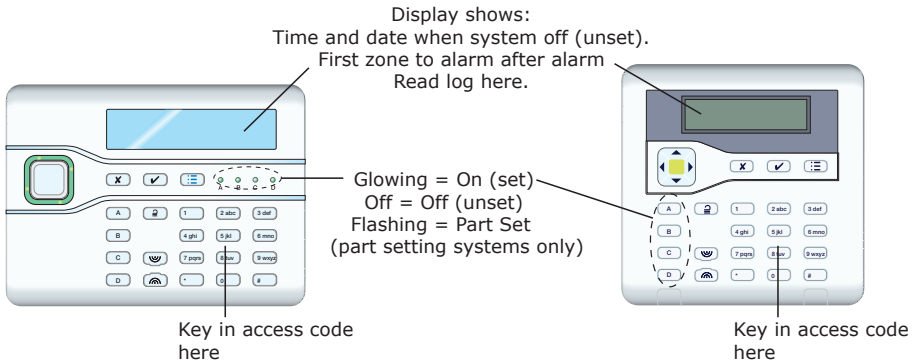

*Depends on programming.

EATON

Powering Business Worldwide

Setting the System:

1. Go to the keypad and key in your access code. (Alternatively, if you have a proximity tag, present your tag to the keypad.)

2. **If you have a Part-Setting System:**

Press:

A - To set the system fully.

or

B, C or D - To part set the system.

If you have a Partitioned System:

Press:

A - To set partition 1.

or

B, C or D - To set partition 2, 3 or 4.

Note: Your installer may have programmed A, B, C and D to have a different function.

3. Leave by the designated exit door or route. The keypad sounds the exit tone and the display shows the remaining exit time in seconds; for example:

```
Setting:Full Set
  10 to set
```

At the end of the exit time, the warning tone stops; you should hear a double-beep confirmation tone. "System Set" is displayed for a few seconds. The installer may also have programmed your external sounder/strobe to flash briefly.

While the system is set, the display shows the standby screen.

If programmed, the LEDs can glow to show if the system is full set (A) or part set (B, C or D).

Unsetting the System:

When unsetting the system, do not stray from the entry route designated by the installer. You may cause an alarm if you do.

1. Enter by the designated entry door or route. The keypad sounds the entry tone. The system starts the entry timer.
2. Go directly to the keypad and either:
Key in your access code
Or
Present your tag to the keypad.
3. The keypad stops the entry tone. The system is unset.

To Silence the Siren:

1. In the event of an alarm, the siren sounds.
2. **If it is safe to enter the premises:**
Go to the keypad and EITHER key in your access code OR present your tag.

The siren stops.

The display shows the first zone to alarm.

```
Press tick to Reset
Burg Z04 Alarm
```

3. Press ✓ to reset the system.
4. The system returns to standby, and is ready to set again.

If the System Will Not Set

Normally, the system will set only when all the detectors are "quiet", that is: not reporting any activity. (This does not apply to those detectors on your exit door or exit/entry route. The system expects these detectors to be active as you leave the protected area.)

If you try to set when one or more detectors are still active then the display shows the words "SETTING FAULTS" and which zones are active. You can make the system "omit" those active zones, either while you are setting the system (see below) or beforehand (see page 4 for instructions on how to omit zones before setting the system).

1. Follow the instructions in *Setting the System*. If any detectors are not yet ready to be set, the top line of the display shows (for example):

```
SETTING FAULTS
Z02 Back door
```

2. EITHER Press ✓ to carry on setting. The system sets with the active zones omitted.
OR Stop the setting process by pressing ✕.

Set by Remote Control

Note: You must program the control unit to recognise ("learn") a remote control or two-way fob, see the Administrator's Guide.

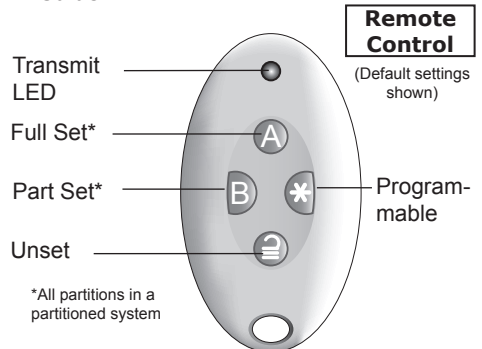

Secure all your windows and doors.

Make sure the system is idle, and that you can hear the warning tones from the keypad.

1. Press the appropriate button on the remote control, either full set (A) or part set (B). The keypad sounds the exit warning tone.
2. Leave by the exit door and make sure it is closed properly (if you have not already done so).

See *Setting the System* opposite.

Set by Two-Way Fob

Note: You must program the control unit to recognise ("learn") a two-way fob, see the i-on Administrator's Guide.

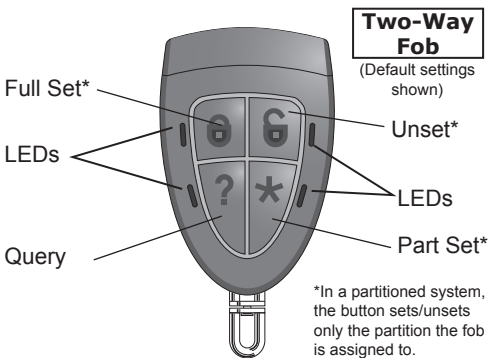

Secure all your windows and doors.

Make sure the system is idle, and leave the protected premises.

1. Press the appropriate button on the fob, either full set ● or part set ✱.
The LED by the button you pressed will flash red.
The system sets immediately.
After a few seconds the LED by the button you pressed will flash green to confirm that the system has set.

Unset by Remote Control

1. Enter by the designated entry door.
2. Press on your remote control.
The system unsets. At this point the system displays the standby screen.

Unset by Two-Way Fob

1. Press on the two way fob.
The LED by the button you pressed flashes red.
The system unsets.
After a few seconds the LED by the unset button flashes green to show that the system is unset.

If The System Will Not Set

If one of the detectors is still active when you try to set the system then you will not hear the exit warning tone.

What happens next depends on how the installer has set up your system.

- a) Try pressing A once more on your remote control (or on the two way fob). If the installer has programmed the system to do so then it will carry on and set, omitting the active detector.
- b) If the system will not set on the second press of button A (or) then you will have to go to the keypad and set the system from there. (The two way fob will flash all of its LEDs red.)

Dealing with Alerts (Why is it Beeping?)

From time to time the control unit may detect that there is a problem with the system. It will try to inform you of this by starting an alert. During an alert the navigation pad glows red, and the keypad will give an short "beep" every few seconds.

Red means Alert

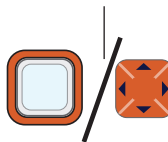

Press



To see the cause of the alert:

1. Make sure the system is unset and that the keypad display shows the standby screen.
2. Press . The display prompts you to key in an access code.
3. Key in a user access code.
The bottom line of the display shows a message describing the most recent active alert. If you press or , the system will show you any other alerts that may be active.
4. **Either:** Press to acknowledge that you have read the alert.

If there are no other alerts, the rim of the navigation pad will glow green and the keypad will return to its standby screen. In addition the keypad will stop beeping.

Or: Press . The rim of the navigation pad will stay red and the system will show the text of the alert the next time you key in an access code.

Note:

1. The keypad(s) will not beep for short interruptions of mains power. If the cause of an alert goes away, then the system will remove the alert message.
2. The system records all alerts in the log, with the time when you acknowledged them.

Omit Zones

You may wish to prevent a zone causing an alarm. For example, if your garage door is protected by a detector, but you wish to leave it unlocked for the delivery of a parcel, you may wish to omit that detector when you set the rest of the system. To do this:

1. Press and key in your access code to enter the User Menu.
2. Press to select *Omit Zones*.
The bottom line of the display shows the first of a list of zones.
3. Press or to display the zone to omit.
4. Press to mark the zone for omission.
The character at the end of the line changes to an "O" to show that the zone will be Omitted.
If you change your mind, press again so that the end of the line shows an "I" (for Included).
5. Repeat steps 2 and 3 for any other zone you wish to omit (or include).
6. Press to store the changes.

The control unit allows you to omit a zone for one setting/unsetting cycle. You will have to omit the zone again for the next setting/unsetting cycle.

View Log

The control unit keeps a log of events (such as alarms and setting/unsetting). To read the log:

1. Press and key in your access code to enter the User Menu.
2. Press until the bottom line of the display shows *View Log*.
3. Press .
4. Press or to scroll through the log.
5. Press to see a more detailed description.
6. Press to finish viewing the log.



WARNING: BEFORE INSTALLING THIS EQUIPMENT, ENSURE THAT THE MAINS SUPPLY FOR THE CONTROL UNIT IS DISCONNECTED AND ISOLATED. All electrical connections must be carried out by a qualified electrician and comply with current local regulations.

Standards and Compliance

The installer must remove or adjust any compliance labelling if he/she selects a non-compliant configuration.
Intrusion compliance: EN 50131-1:2007+A1:2009; EN 50131-3:2009; EN 50131-5-3:2005+A1:2008; EN 50131-3-10:2014; EN 50136-1:2012; BS8243:2010; PD 6662:2010; IA 1501:2015.

Environmental class: Class II.

Alarm transmission: When using either the built-in SIA-IP function or a plug-on communicator as a single-path solution, this meets EN 50136-1 ATS category SP2. When using the built-in SIA-IP function and a plug-on communicator as a dual-path solution, this meets EN 50136-1 ATS category DP1.

Security grade: Grade 2.

Radio frequency: 868.6625MHz narrowband.

Radio standards: EN 300-220-2, EN 300-489-1, EN 300-489-3.

Transmitter range: Up to 500m in free space. Also dependent on device type and environment; please refer to the radio device's installation instructions.

Mains power supply: 230VAC + 10%/-15%, 50Hz.

This product complies with the requirements of EN50131-6 Type A power supply at Grade 2 and environmental class II.

SIMPLIFIED EU DECLARATION OF CONFORMITY

Hereby, Eaton Electrical Products Ltd declares that the radio equipment type i-on30R/40H is in compliance with Directive 2014/53/EU.

The full text of the EU declaration of conformity is available at the following internet address:
www.touchpoint-online.com

The information, recommendations, descriptions and safety notations in this document are based on Eaton Corporation's ("Eaton") experience and judgment and may not cover all contingencies. If further information is required, an Eaton sales office should be consulted. Sale of the product shown in this literature is subject to the terms and conditions outlined in appropriate Eaton selling policies or other contractual agreement between Eaton and the purchaser.

THERE ARE NO UNDERSTANDINGS, AGREEMENTS, WARRANTIES, EXPRESSED OR IMPLIED, INCLUDING WARRANTIES OF FITNESS FOR A PARTICULAR PURPOSE OR MERCHANTABILITY, OTHER THAN THOSE SPECIFICALLY SET OUT IN ANY EXISTING CONTRACT BETWEEN THE PARTIES. ANY SUCH CONTRACT STATES THE ENTIRE OBLIGATION OF EATON. THE CONTENTS OF THIS DOCUMENT SHALL NOT BECOME PART OF OR MODIFY ANY CONTRACT BETWEEN THE PARTIES.

In no event will Eaton be responsible to the purchaser or user in contract, in tort (including negligence), strict liability or otherwise for any special, indirect, incidental or consequential damage or loss whatsoever, including but not limited to damage or loss of use of equipment, plant or power system, cost of capital, loss of power, additional expenses in the use of existing power facilities, or claims against the purchaser or user by its customers resulting from the use of the information, recommendations and descriptions contained herein. The information contained in this manual is subject to change without notice.

© 2016 Eaton.

Eaton, Security House, Vantage Point Business Village, Mitcheldean, GL17 0SZ. www.touchpoint-online.com

Product Support (UK) Tel: +44 (0) 1594 541978 available 08:30 to 17:00 Monday to Friday. email: securitytechsupport@eaton.com

Part number 12666827 Issue 1 13/05/16

